

Creekview Corporate Center II

1300 E. Lookout, Richardson, Tx.

Building Amenities

Day porter
 Surface Parking: 1:250
 Covered parking: 1:1,000
 Telephone Entry System for visitors
 After-hours cardkey access

Total Building Size: 151,073 sf
 Percentage Leased: 86%
 Rental Rate: \$22.00 + E
 2009 Est. Electrical: \$2.21/sf
 Common Area Factor: 14.48%
 TI allowance: Negotiable
 Term: 3-5 Years
 Year Built: 2001



Typical Floor Plate

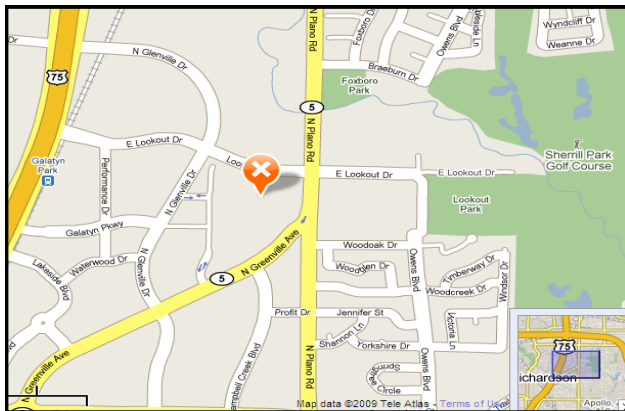
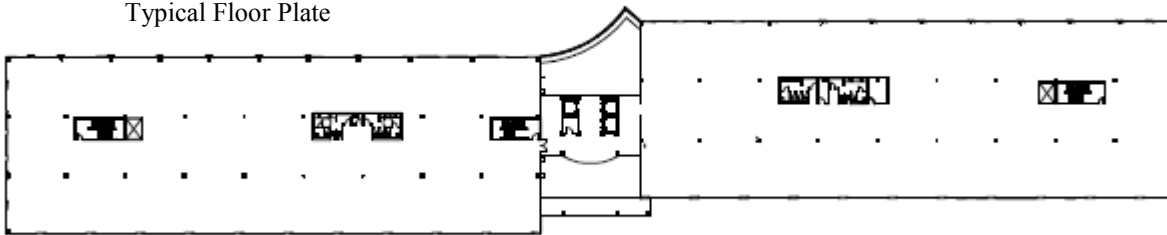

Available Suites

Suite 120	11,370
Suite 140	4,067
Suite 145	3,522
Suite 318	1,683

Contact:

Deborah Borum
 972.231.6693 (direct)
 214.208.2878 (cell)
dborum@beltwayco.com

Beltway Commercial Real Estate
www.beltwayco.com

